

# SCHEDULE A MAP 02

By-Law No. 6-2003 as amended  
by By-law No. 44-2003

Date Passed July 9, 2003

Mayor Larry J Miller

Deputy-Clerk Bruce Hoffman

## ZONES

- A1** General Rural
- A2** Restricted Rural
- R1** General Residential
- R2** Inland Lake and Shoreline Residential
- R3** Low Density Residential
- R4** Medium Density Residential
- R5** Medium-High Density Residential
- R6** Mobile Home Park
- C1** General Commercial
- C2** Rural Commercial
- C3** Tent and Trailer Campground
- C4** Space Extensive Commercial
- M1** General Industrial
- M2** Extractive Industrial
- I** Institutional
- OS** Open Space
- EP** Environmental Protection
- PD** Planned Development
- Niagara Escarpment Development Control
- Wetland
- Hamlet
- 1** Zone Exception
- h** Holding Provision
- Municipal Road
- County Road or Provincial Highway
- Other Right of Way or Road Allowance
- Waterway

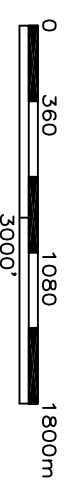

JANUARY 22 2003 - CUESTA PLANNING  
AMENDED AUGUST 2010

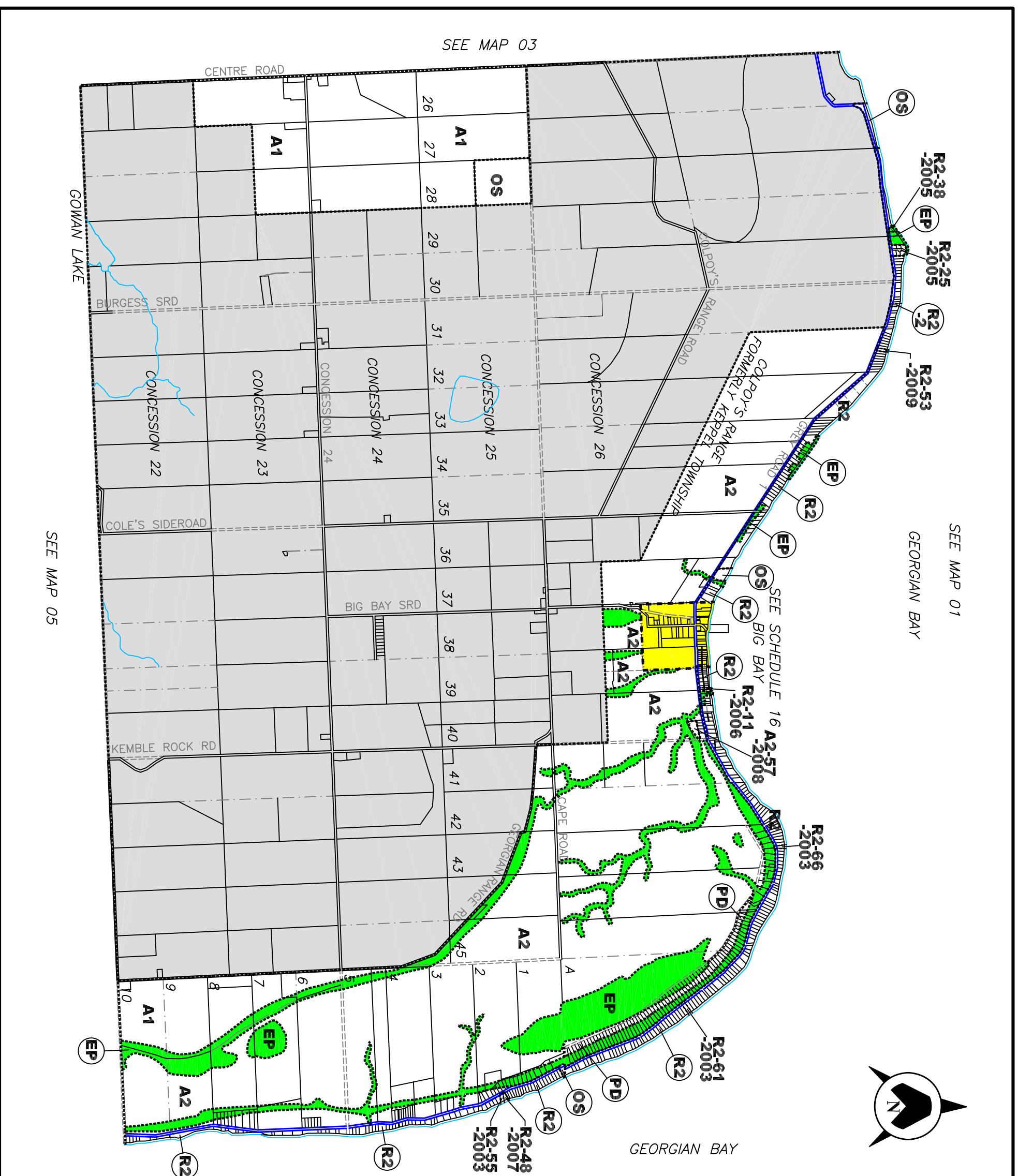

SEE MAP 01

GEORGIAN BAY

SEE MAP 03

CENTRE ROAD

GOWAN LAKE

BURGESS SRD

CONCESSION 22

CONCESSION 23

CONCESSION 24

CONCESSION 24

CONCESSION 25

CONCESSION 26

COLE'S SIDEROAD

BIG BAY SRD

KEMBLE ROCK RD

CAPE ROAD

GEORGIAN RANGE RD

GEORGIAN BAY

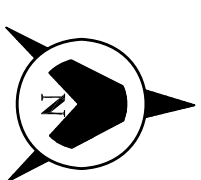

SEE MAP 05