

- NOTES:**
- SEPTIC SYSTEM DESIGN IS BASED ON GM BLUEPLAN'S D-5-4 REPORT FOR 4 BEDROOM (200m² FINISHED FLOOR AREA) DWELLING. DAILY DESIGN SEWAGE FLOW IS 2,000 L/DAY.
 - ALTERNATE DESIGN MAY BE CONSIDERED AT THE TIME OF APPLYING FOR A SEPTIC PERMIT.
 - BUILDING, DRIVEWAY AND SEPTIC SYSTEM LOCATIONS SHOWN ON THIS PLAN ARE PRELIMINARY. IF AT THE TIME OF THE APPLICATION FOR BUILDING PERMIT THE LAND OWNER/BUILDER WANTS TO DEVIATE FROM THIS PLAN, THAT MAY BE PERMITTED SUBJECT TO APPROVAL FROM THE TOWNSHIP OF GEORGIAN BLUFFS AND THE GREY SAUBLE CONSERVATION AUTHORITY.
 - WATER SUPPLY TO BE PROVIDED BY SHORE WELLS.
 - DRIVEWAY TO BE CONSTRUCTED OF COMPACTED 300mm GRANULAR 'B' AND 100mm GRANULAR 'A'.
 - FOM, FOM, SWT2-5, MAS2, CUM1-1 LINEWORK OBTAINED FROM SAAR ENVIRONMENTAL LTD'S EIS DATED SEPTEMBER 2023.
 - THIS SERVICING PLAN HAS BEEN PREPARED IN CONFORMANCE WITH THE COASTAL REPORT.

TOPOGRAPHIC SURVEY COMPLETED BY SMC GEOMATICS ON OCTOBER 27, 2020

LOT LEGAL LINE INFORMATION TAKEN FROM PLAN OF SURVEY OF PART OF LOT 11 JONES RANGE TOWNSHIP OF KEPPEL COUNTY OF GREY, BY VAN HARTEN SURVEYING INC. BY RONALD MAK DATED MAY 17, 2022. LEGAL INFORMATION WAS INTERPRETED AS BEST AS POSSIBLE WITH AVAILABLE SURVEY BARS DISCOVERED IN THE FIELD. IT IS RECOMMENDED THAT AN OLS CONFIRM ALL PROPERTY LIMITS

- LEGEND**
- EX. PROPERTY BOUNDARY
 - PROPOSED PROPERTY BOUNDARY
 - PROPOSED BUILDING OUTLINE
 - ALTERNATE BUILDING OUTLINE
 - BUILDING ENVELOPE (SR ZONE)
 - ROAD CENTRE LINE
 - EDGE OF STREET / DRIVEWAY
 - PROPOSED SWALE
 - EXISTING DITCH
 - EX. CONTOUR LINE
 - EX. TREE LINE
 - PROPOSED SWALE ELEVATION
 - EXISTING HYDRO POLE
 - STANDARD IRON BAR FOUND
 - IRON BAR FOUND
 - FLOW ARROW
 - DRY-MOIST OLD FIELD MEADOW TYPE WITH PATCHY SUCCESSION OF SWT2-5
 - DRY-FRESH WHITE CEDAR-WHITE BIRCH-WHITE AND GREEN ASH-MAPLE
 - SWT2-5
 - RED-OSIER MINERAL THICKET SWAMP TYPE (SUCCESIONAL ELEMENTS)
 - MAS2
 - MINERAL SHALLOW MARSH ECOSITE (CATTAILS-WILLOW-BUCKTHORN-WHITE ASH-WINTERBERRY-WHITE BIRCH-SUGAR MAPLE-FERAL APPLE)
 - PROPOSED SEPTIC ENVELOPE

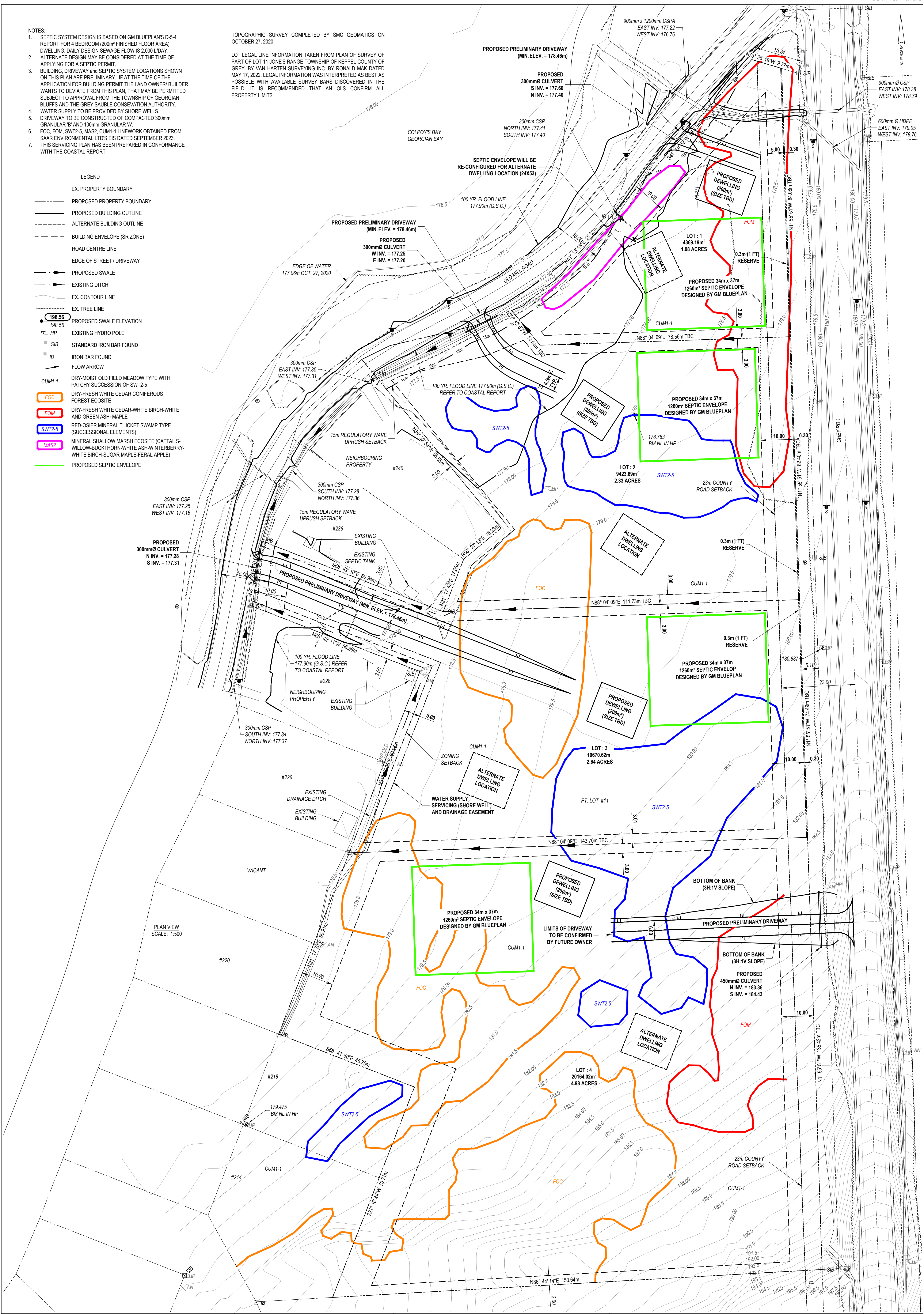

BM 180.887 NAIL IN HYDRO POLE ALONG GREY RD 1 NEAR CENTER OF EAST SIDE OF LOT.
 AND GREY ROAD 1
 BM 178.783 NAIL IN HYDRO POLE ON THE NORTH SIDE OF THE INTERSECTION OF OLD MILL ROAD
 AND GREY ROAD 1
 BM 179.475 NAIL IN HYDRO POLE AT SOUTH WEST CORNER OF LOT BETWEEN 214 AND 218 OLD
 MILL ROAD.

CAUTION:
 THE POSITION OF POLE LINES, CONDUITS, WATERMANS, SEWERS AND OTHER UNDERGROUND AND
 ABOVE GROUND UTILITIES AND STRUCTURES IS NOT NECESSARILY SHOWN ON THE CONTRACT
 DRAWINGS. AND, WHERE SHOWN, THE ACCURACY OF THE POSITION OF SUCH UTILITIES AND
 STRUCTURES IS NOT GUARANTEED. BEFORE STARTING WORK, THE CONTRACTOR SHALL INFORM
 HIMSELF OF THE EXACT LOCATION OF ALL SUCH UTILITIES AND STRUCTURES, AND SHALL ASSUME
 ALL LIABILITY FOR DAMAGE TO THEM.

DATE	REVISION / ISSUE

DARRYL M. ROBINS
CONSULTING INC.

4844 Highway No. 6, General Delivery,
 Miller Lake, Ontario
 Phone / Fax: 519 795-7094

www.dmrconsulting.ca
 Email: dmr@dmrconsulting.ca

LICENSED PROFESSIONAL ENGINEER
 L. A. SWANSON
 100079228
 Nov 14/23
 PROVINCE OF ONTARIO

CLIENT: COLLEEN NEWELL

DESIGN	D.M.R.
DRAWN	W.K.
CHECKED	D.M.R.
DATE	mm/dd/yyyy 11/11/20
PROJECT No.	20046
SCALE	1:500
FIG.	M20046-SP3